



## Cumberland Park, W3

LONG LET: One-bedroom ground floor flat with direct garden access, set within a sought-after development in Cumberland Park, Acton.

- One-bedroom apartment
- Ground floor
- Open-plan kitchen/living
- Built-in wardrobe
- Elizabeth Line & Overground
- Private garden

£2,400 Per Month

## Cumberland Park

Approximate Gross Internal Area  
603 sq ft - 56 sq m

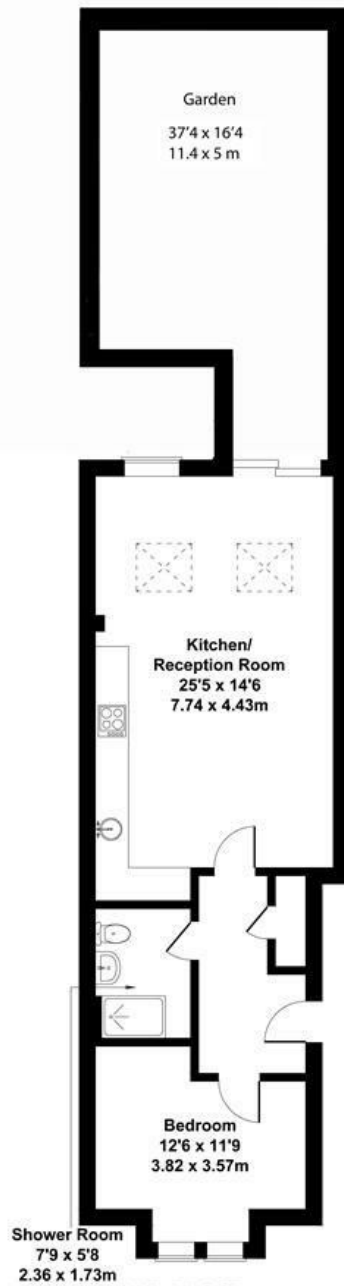

### GROUND FLOOR

Not to Scale. Produced by The Plan Portal 2025  
For Illustrative Purposes Only.

Energy Efficiency Rating		
	Current	Potential
Very energy efficient - lower running costs		
(92 plus) <b>A</b>		
(81-91) <b>B</b>		
(69-80) <b>C</b>		
(55-68) <b>D</b>		
(39-54) <b>E</b>		
(21-38) <b>F</b>		
(1-20) <b>G</b>		
Not energy efficient - higher running costs		
<b>England &amp; Wales</b>	EU Directive 2002/91/EC	